

VERIFICHE URBANISTICHE COMPARTO 1

Scala 1:200

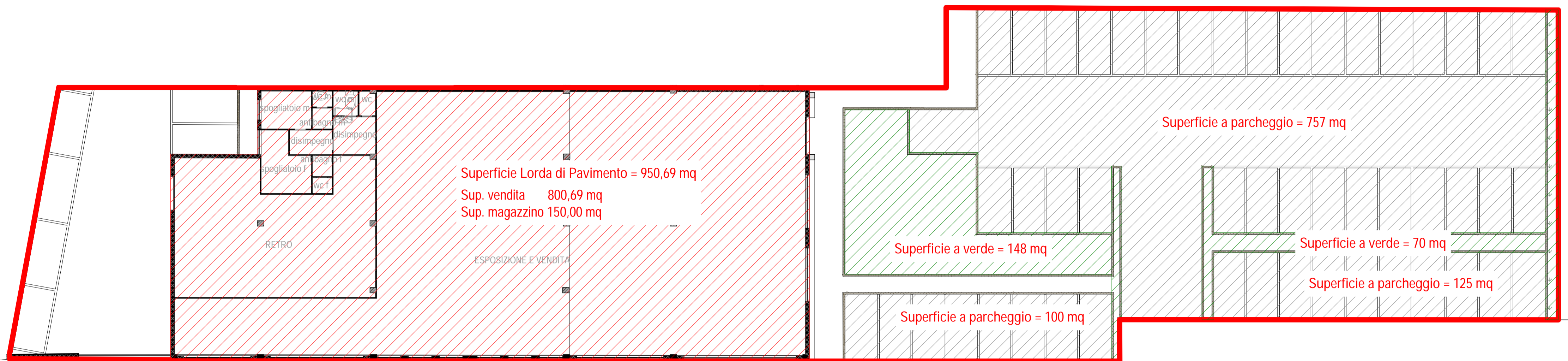

SUPERFICIE COMPARTO 1

Scala 1:200

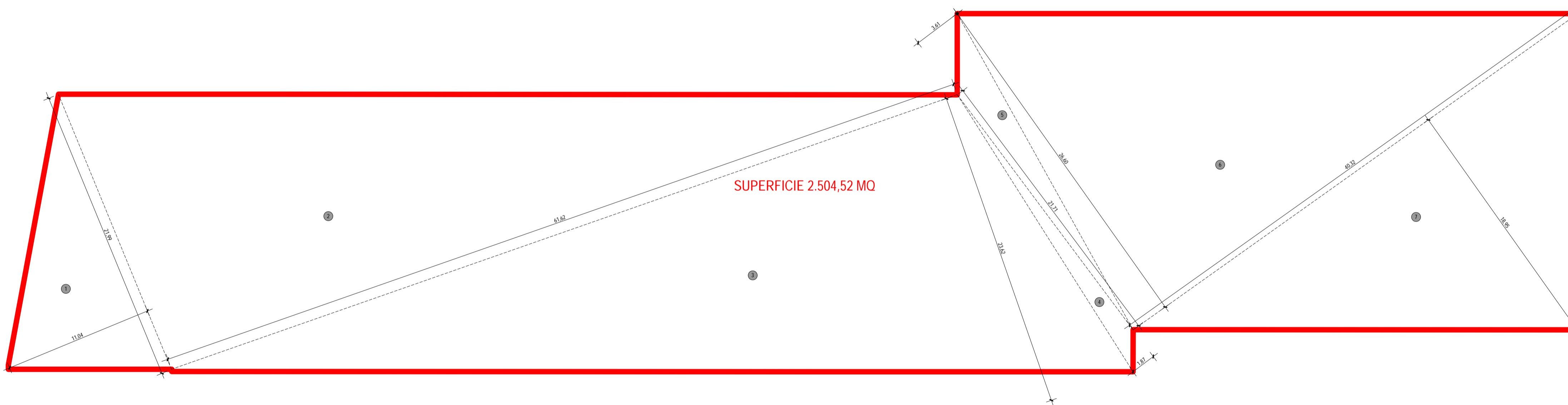

SUPERFICIE COPERTA COMPARTO 1

Scala 1:200

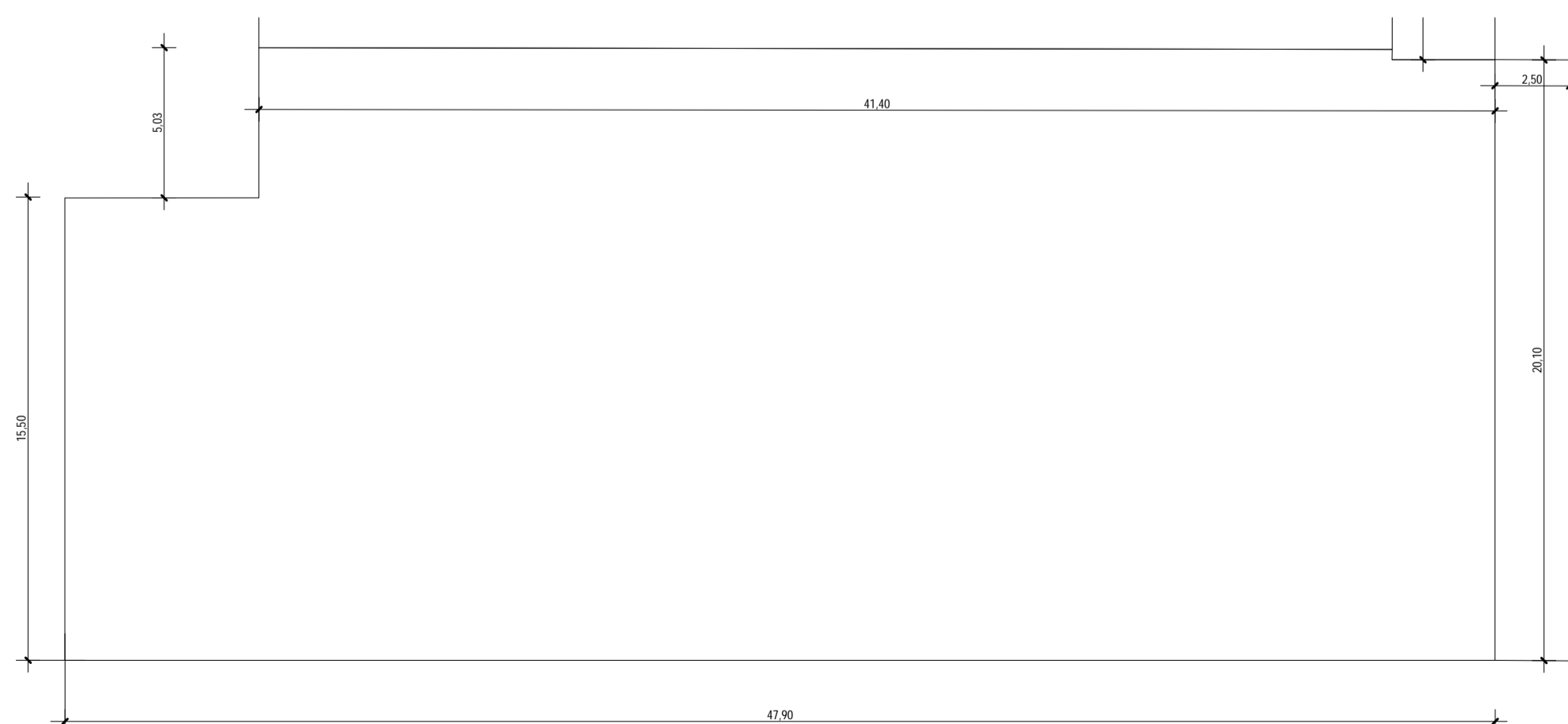

SUPERFICIE COPERTA COMPARTO 1 (MQ)			
Sup = A x B			
	A	B	
	15,50	47,90	742,45
	5,03	41,40	208,24
	20,10	2,50	50,25
	TOT.		1.000,94

KEY MAP COMPARTI

Scala 1:1000



SUPERFICIE FONDIARIA COMPARTO 1 (MQ)			
Sup = (A x B)/2			
	A	B	
1	21,99	11,04	121,38
2	61,62	21,99	677,51
3	61,63	23,62	727,85
4	21,71	1,87	20,30
5	21,71	3,61	39,19
6	40,32	26,60	536,26
7	40,32	18,95	382,03
	TOT.		2.504,52

SLP COMPARTO 1 (MQ)			
Sup = A x B			
	A	B	
	15,50	47,90	742,45
	5,03	41,40	208,24
	TOT.		950,69

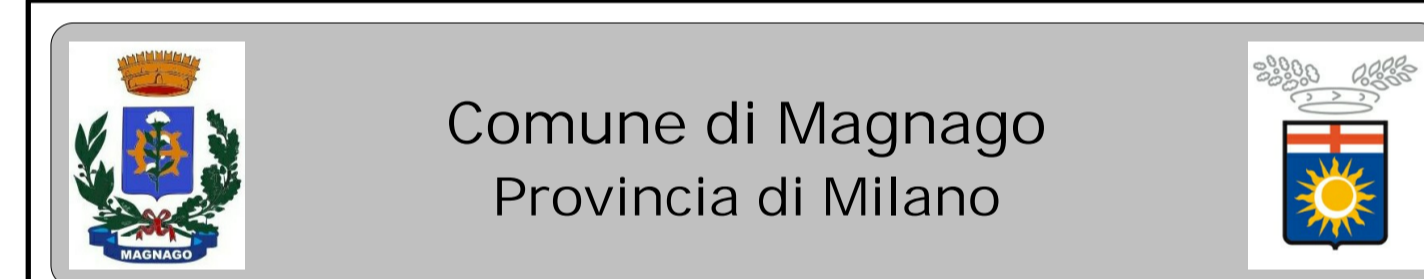

Comune di Magnago
Provincia di Milano

PROGRAMMA INTEGRATO DI INTERVENTO PER IL RECUPERO DELL'AREA DISMESSA EX FOCREM



PROGETTISTA:
INGECO S.R.L.
CORSO MAGENTA 144
LEGNANO
Tel: 0331547367
e-mail: INGECO@INWIND.IT

COMMITTENTE:
GEMMA S.R.L.
VIA MAMELI 23 BUSTO ARSIZIO

TAVOLA

11

ELABORATO

VERIFICHE URBANISTICHE
COMPARTO 1

scala

1:200

protocollo

3260

revisione

data

NOVEMBRE 2018